



Greens to Green Conservancy

at FASNY White Plains



Welcome to our Dialogue & Field Visit

Background

French-American School of New York

- For over thirty years, The French-American School of New York has been providing a bilingual, bicultural French and American education to an American, French and International student population
- FASNY currently educates 865 students per year from Nursery to Grade 12
- FASNY students and families represent more than 40 nationalities
 - 47% American Citizens
 - 53% International
- Currently renting 3 separate campuses in Scarsdale, Larchmont, and Mamaroneck
- On January 20, 2011 FASNY purchased the former Ridgeway Country Club in White Plains and has been planning the sustainable and clustered development of a new unified campus on approximately 46 acres of the property
- **FASNY created a Conservancy Task Force with the objective of identifying the best use of the 84 acres of permanent open space as an extension of the FASNY Campus and educational program**

Our Philosophy & Our Approach

Our Guiding Question

*“How can we realize the unique opportunity for
our new campus and utilize the land
for the benefit of children and the environment
in a way that embodies and furthers
our vision, values, and educational mission
within the local community?”*

Our Philosophy & Our Approach

Our Driving Questions

- 1st How does this align with our Mission, Vision & Values?**
- 2nd How does this benefit the FASNY Community and the local Community?**
- 3rd How does this create Educational, Environmental and Growing Opportunities?**
- 4th How does this efficiently utilize our Resources?**
- 5th How does this ensure the Safety of our Children and the Security of the Neighborhood?**
- 6th How does this contribute to our Comprehensive Master Plan?**





WHITE PLAINS
CAMPUS

FRENCH-AMERICAN SCHOOL OF NEW YORK

The New Campus

French-American School of New York





WHITE PLAINS
CAMPUS

FASNY FRENCH-AMERICAN SCHOOL OF NEW YORK

The New Campus

French-American School of New York

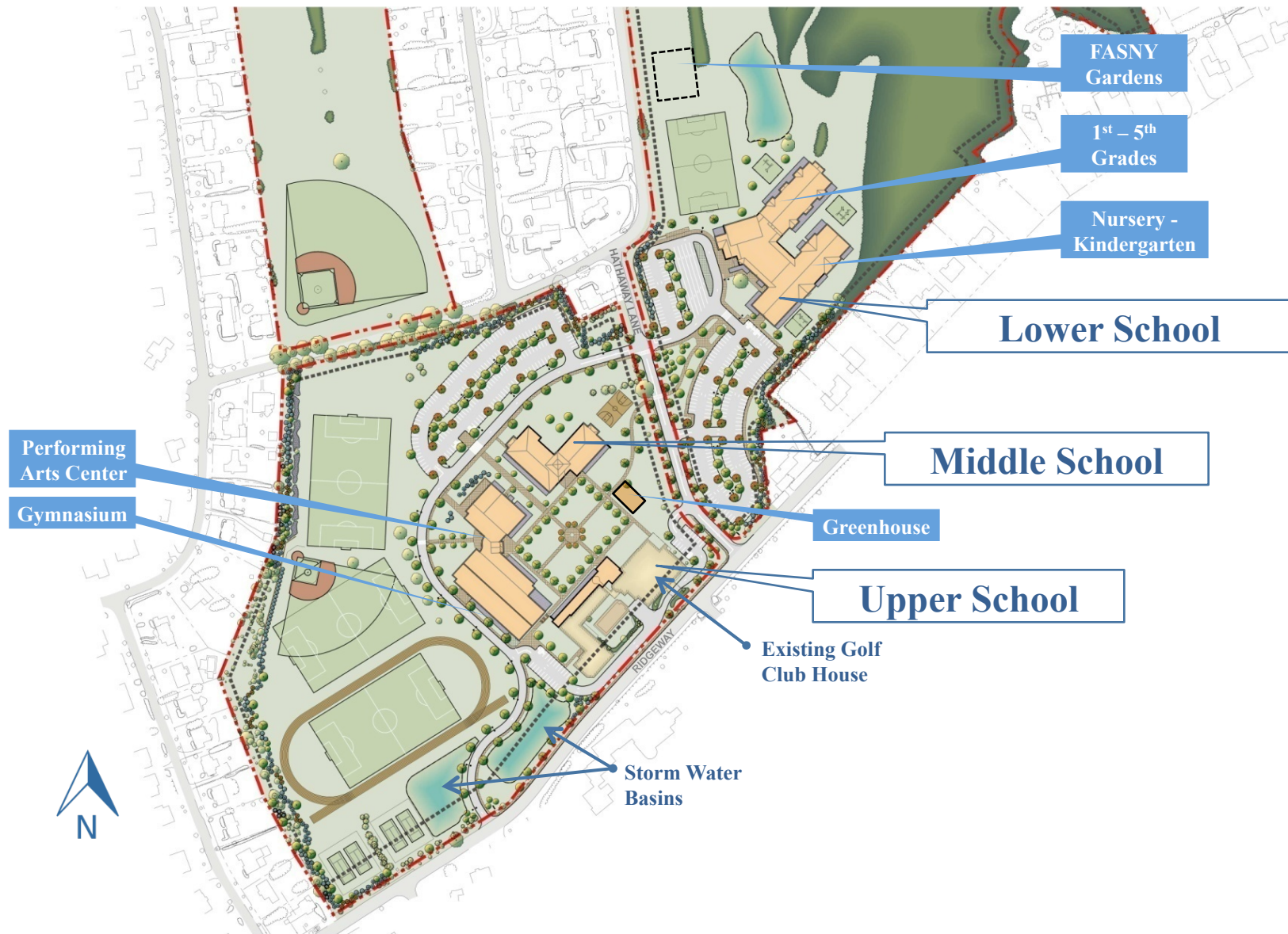

Sustainable Campus

French-American School of New York

We will utilize the following Sustainable Design Concepts:

Clustered Campus Development

- **Clustering to preserve Open Space is a “best practices” planning tool**

Sustainable Storm Water Management

- **Vegetated Swales**
- **Pervious Paving**
- **Disconnected Impervious Surfaces**
- **Building Planters**
- **Vegetated Storm Water Basins**

Sustainable Building Design

- **Day Lighting**
- **Renewable Energy**
- **Rainwater Harvesting**
- **Low Flow Fixtures**
- **Recycled Building Materials**

Greens to Green Conservancy

French-American School of New York



Greens to Green Conservancy

French-American School of New York

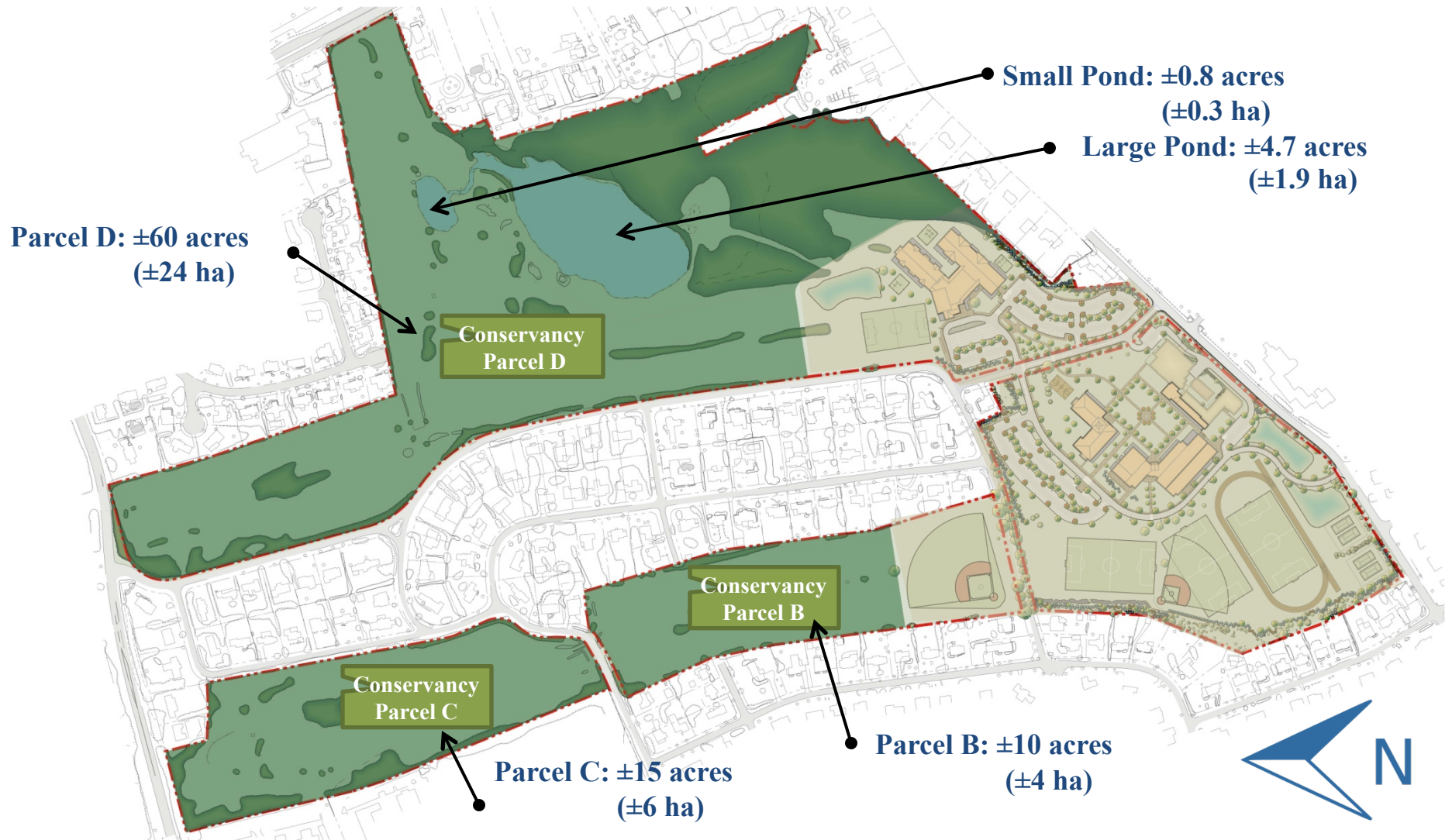

3 Parcels ±84 Acres (±34 ha)

Greens to Green Conservancy

French-American School of New York

Why Greens to Green?

Greens to Green converts 84 acres of private golf course “*Greens*” into a restored natural “*Green*” open space for passive use and conservation

Why a Conservancy?

We are NOT a Park

- We prioritize low impact and passive use

We are NOT a Nature Center

- We prioritize education but do not have a Nature Center that runs active public programs that attract many visitors

We are a Conservancy

- We prioritize the conservation of nature and educational natural resources
- We are not preserving a golf course but are progressively restoring and revitalizing natural resources and a diversity of ecological habitats
- We are inclusive and we welcome members of the community who would like to join in realizing and sustaining this unique opportunity

Greens to Green Conservancy

French-American School of New York

Ownership

- The Conservancy will be owned by the French-American School of New York

Permanent Conservation Easement

- The Conservancy will be deeded as perpetual open space

Maintenance

- FASNY will be fully responsible for the maintenance of the Conservancy just like it will be responsible for the maintenance of the Campus

Security

- FASNY will be fully responsible for the security of the Conservancy just like it will be responsible for the security of the Campus

Low-Intensity Use

- The Conservancy will serve as a natural extension of the school and will augment FASNY's educational mission

Local Access

- FASNY is offering the neighborhood open access to the Conservancy with limited hours from dawn to dusk

Greens to Green Conservancy



What are the Environmental Opportunities?



Greens to Green Conservancy

Existing Natural Features



Environmental

Overlapping Diverse Bio-Habitats

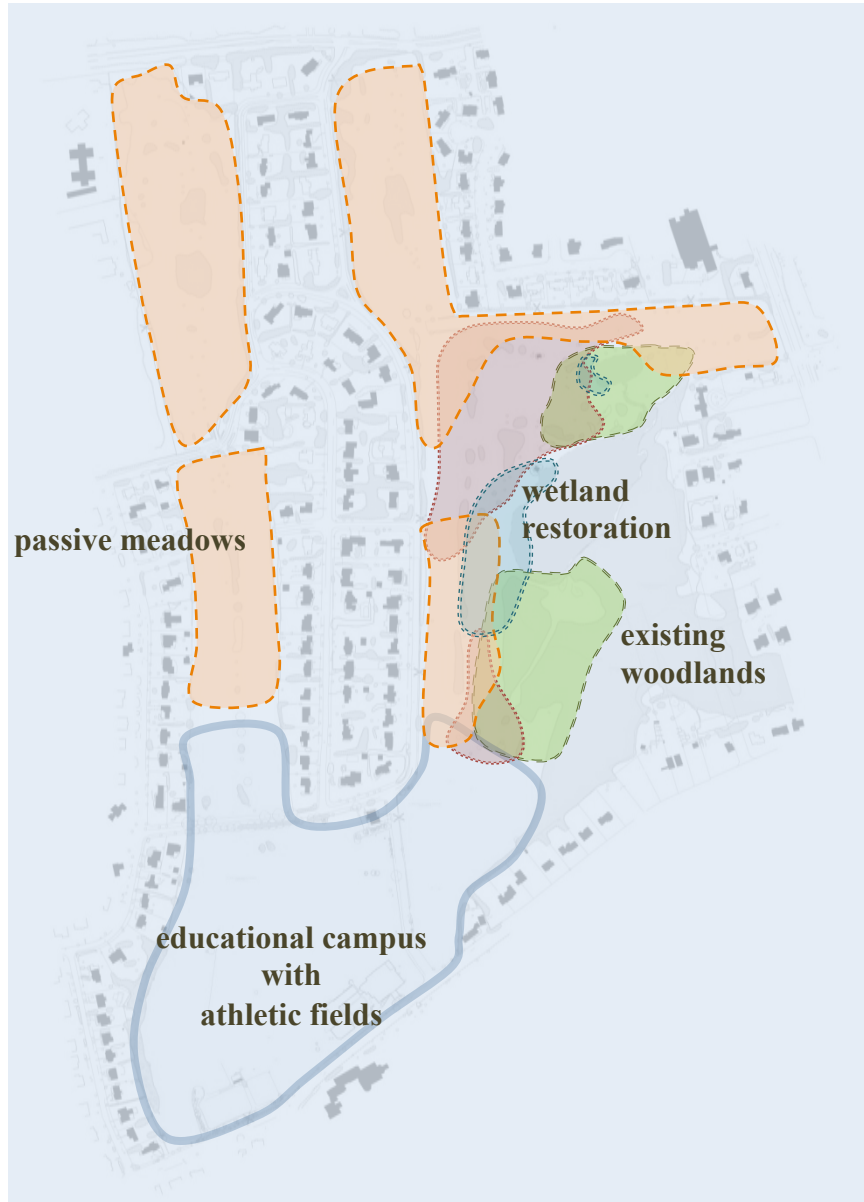

 **Grassland/ Wildflower Meadow**



 **Successional Shrub Land**



 **Shallow Emergent Marsh**



 **Red Maple Hardwood Swamp**

Greens to Green Conservancy



What are the Educational Opportunities?



Educational Opportunities for Education & Observation

- FASNY outdoor learning spaces
- Aquatic ecosystem observation
- Outlook points
- Interpretive signage

- Woodland clearing
- Wetland & Woodland outlooks with bird blinds



Greens to Green Conservancy



What are the Growing Opportunities?



Growing Indoor & Outdoor Opportunities



Greens to Green Conservancy



What are the Community Opportunities?



Our Neighborhood



Low Impact Passive Use

Trails

Ecologically Sensitive

ADA Handicapped Accessible



Neighborhood Access & Security

DRAFT CONCEPT

A = Pedestrian Access

B = Bicycle Rack

C = Campus Pedestrian Entrance

P = Gravel Parking and Bicycle Rack

F = Additional Fencing

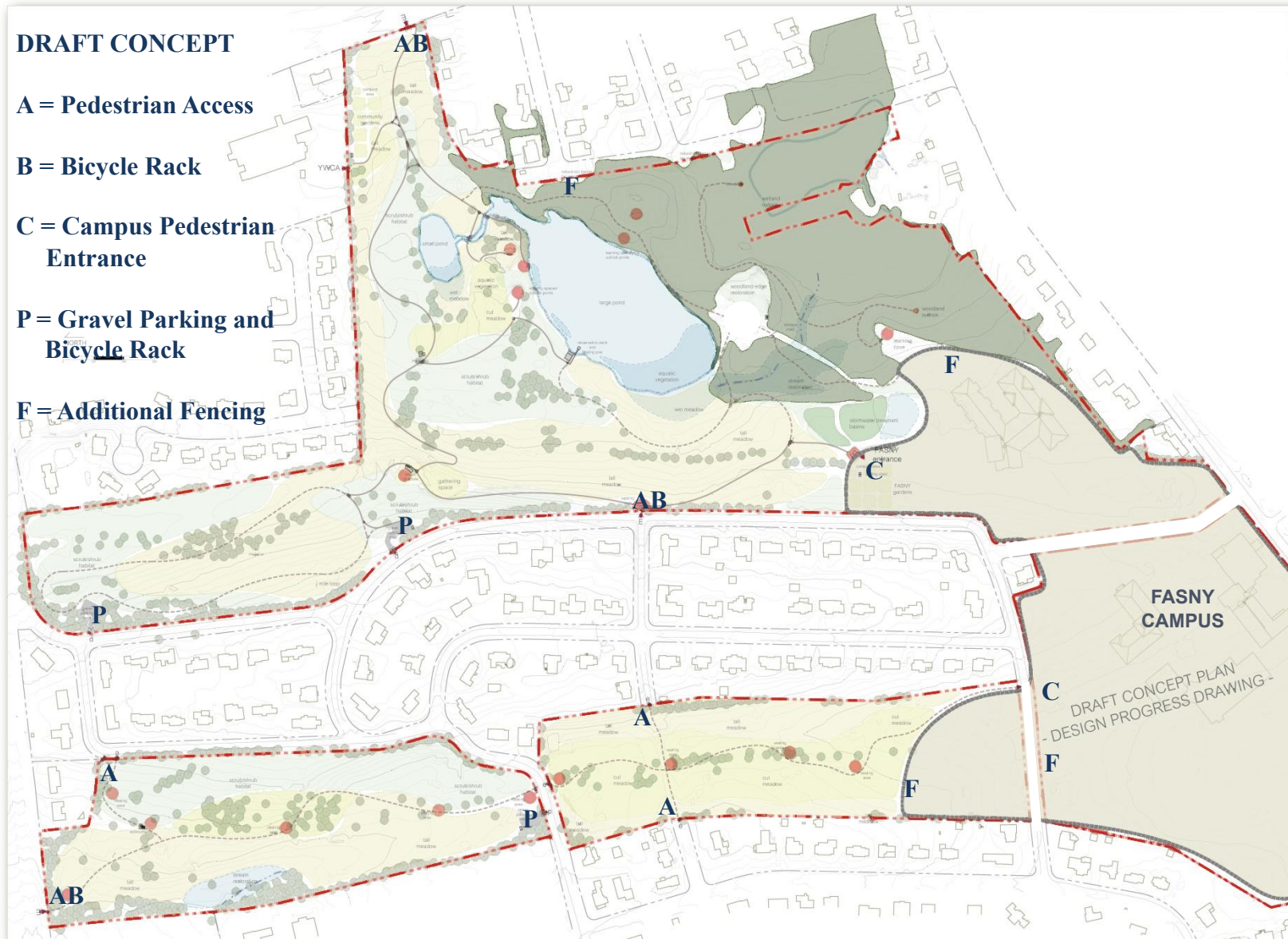

Greens to Green Conservancy

Golf Courses vs. Natural Open Space

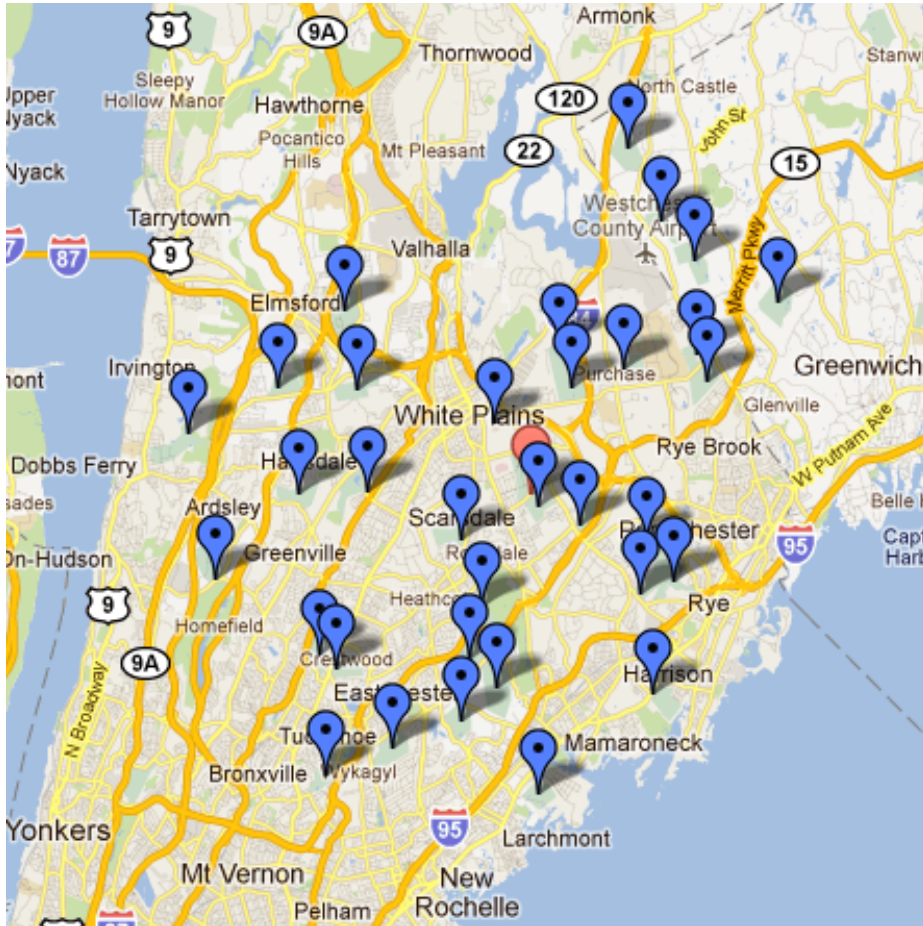

32 Golf Courses within 10 Miles

- 32 Public and Private Golf Courses are within 10 miles of the former Ridgeway Country Club
- The Greens to Green Conservancy at FASNY will be a substantial addition to the publicly accessible natural open space in the City of White Plains
- Meadows are an endangered and valuable habitat for diverse bird species
- FASNY is no longer using harmful pesticides and is no longer irrigating golf course fairways and greens

Historical Use

“Greens to Green”

Golf Courses are struggling and the industry is in secular decline

- **Ridgeway Country Club was unable to remain viable as a golf course**
- **Ridgeway Country Club was not successful in increasing membership**
- **The City of White Plains studied the feasibility of a public golf course and voted against it**
- **Several other golf courses are under similar pressure – there are already too many competing golf courses in the area**

Historical Use

- **Before this land was a private golf course and country club, it was the Gedney Farm for over 200 years**
- **Prior to being developed into Gedney Farm, this land was a natural and undeveloped space**
- **We are restoring this land to a well-managed natural diverse habitat**

How You Can Help

Sign our **Online Petition** at www.GreenstoGreen.org/petition and forward to friends

Support FASNY's application with White Plains Common Council & Mayor

- Send **supportive letters or emails** to White Plains Mayor and Common Council
- Attend **Public Hearings** during DEIS public comment period and encourage others (especially those connected to White Plains) to come show their support

Become an Ambassador for FASNY in White Plains

- **Discuss** the benefits of FASNY's plans with White Plains restaurants, merchants, residents of White Plains, nature enthusiasts, organizations you belong to...
- Send **Letter to the Editor** of one of our local papers to demonstrate public support

Learn more about FASNY's New Campus and Conservancy www.GreenstoGreen.org

Greens to Green Conservancy

French-American School of New York



Thank you!